



SD1 - COVER SHEET

3/25/2022

LOWER VALLEY REGIONAL HUMAN SERVICES FACILITY - 21032
NEW PHASED DEVELOPMENT

Information shown on this drawing sheet is PRELIMINARY & NOT FOR CONSTRUCTION



RESIN
ARCHITECTURE

305 1st STREET,
IDAHO FALLS, ID 83401
PH: 208.757.5700
<https://www.resinarchitecture.com/>

THESE PLANS, DRAWINGS, AND DESIGNS ARE THE EXCLUSIVE PROPERTY OF RESIN ARCHITECTURE, LLC AND SHALL NOT BE REPRODUCED IN ANY FORM WITHOUT WRITTEN CONSENT. ALL RIGHTS RESERVED © 2022 RESIN ARCHITECTURE, LLC.

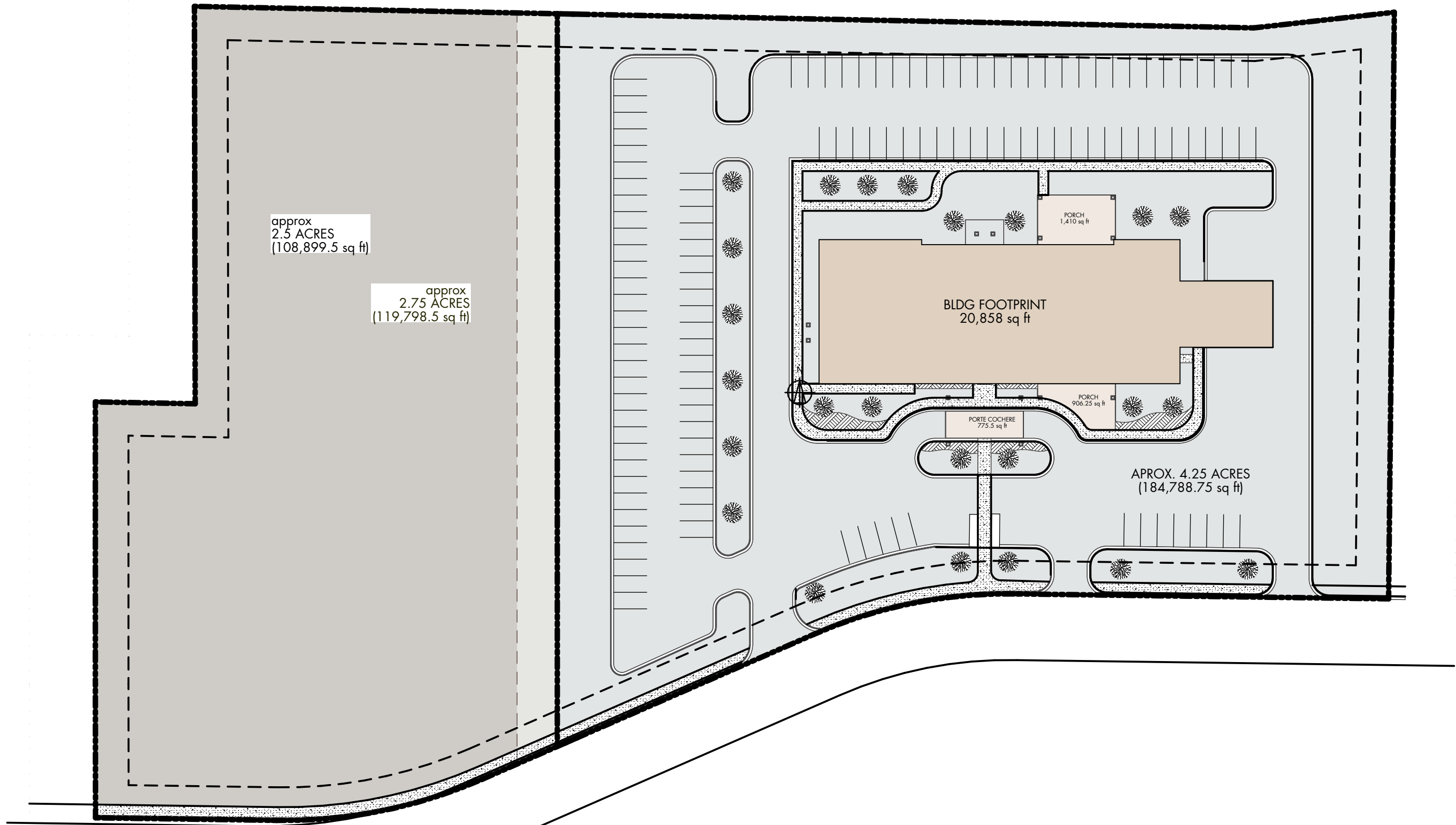

1 ARCHITECTURAL SITE PLAN
SCALE: 1:720

SD2 - ARCHITECTURAL SITE PLAN

3/25/2022

LOWER VALLEY REGIONAL HUMAN SERVICES FACILITY - 21032
NEW PHASED DEVELOPMENT



RESIN
ARCHITECTURE

305 1st STREET,
IDAHO FALLS, ID 83401
PH: 208.757.5700
<https://www.resinarchitecture.com/>

THESE PLANS, DRAWINGS, AND DESIGNS ARE THE EXCLUSIVE PROPERTY OF RESIN ARCHITECTURE, LLC AND SHALL NOT BE REPRODUCED IN ANY FORM WITHOUT WRITTEN CONSENT. ALL RIGHTS RESERVED © 2022 RESIN ARCHITECTURE, LLC.

Information shown on this drawing sheet is PRELIMINARY & NOT FOR CONSTRUCTION



2 FIRST FLOOR PLAN
SCALE: 1:288

SD3 - FIRST FLOOR PLAN

3/25/2022



RESIN
ARCHITECTURE

305 1st STREET,
IDAHO FALLS, ID 83401
PH: 208.757.5700
<https://www.resinarchitecture.com/>

LOWER VALLEY REGIONAL HUMAN SERVICES FACILITY - 21032
NEW PHASED DEVELOPMENT

THESE PLANS, DRAWINGS, AND DESIGNS ARE THE EXCLUSIVE PROPERTY OF RESIN ARCHITECTURE, LLC AND SHALL NOT BE REPRODUCED IN ANY FORM WITHOUT WRITTEN CONSENT. ALL RIGHTS RESERVED © 2022 RESIN ARCHITECTURE, LLC.

Information shown on this drawing sheet is PRELIMINARY & NOT FOR CONSTRUCTION



CONTINUED ON NEXT SHEET

1 PARTIAL FIRST FLOOR PLAN
 SCALE: 1/16" = 1'-0"

SD12 - ENLARGED PLAN WEST

3/25/2022



RESIN
 ARCHITECTURE

305 1st STREET,
 IDAHO FALLS, ID 83401
 PH: 208.757.5700
<https://www.resinarchitecture.com/>

LOWER VALLEY REGIONAL HUMAN SERVICES FACILITY - 21032
 NEW PHASED DEVELOPMENT

CONTINUED ON PREVIOUS SHEET



1

PARTIAL FIRST FLOOR PLAN

SCALE: 1/16" = 1'-0"

SD13 - ENLARGED PLAN EAST

3/25/2022

LOWER VALLEY REGIONAL HUMAN SERVICES FACILITY - 21032 NEW PHASED DEVELOPMENT



305 1st STREET,
IDAHO FALLS, ID 83401
PH: 208.757.5700
<https://www.resinarchitecture.com/>



SD6 - EXTERIOR VIEW

3/25/2022

LOWER VALLEY REGIONAL HUMAN SERVICES FACILITY - 21032
NEW PHASED DEVELOPMENT

Information shown on this drawing sheet is PRELIMINARY & NOT FOR CONSTRUCTION



RESIN
ARCHITECTURE

305 1st STREET,
IDAHO FALLS, ID 83401
PH: 208.757.5700
<https://www.resinarchitecture.com/>

THESE PLANS, DRAWINGS, AND DESIGNS ARE THE EXCLUSIVE PROPERTY OF RESIN ARCHITECTURE, LLC AND SHALL NOT BE REPRODUCED IN ANY FORM WITHOUT WRITTEN CONSENT. ALL RIGHTS RESERVED © 2022 RESIN ARCHITECTURE, LLC.



SD7 - EXTERIOR VIEW

3/25/2022

LOWER VALLEY REGIONAL HUMAN SERVICES FACILITY - 21032
NEW PHASED DEVELOPMENT

Information shown on this drawing sheet is PRELIMINARY & NOT FOR CONSTRUCTION



RESIN
ARCHITECTURE

305 1st STREET,
IDAHO FALLS, ID 83401
PH: 208.757.5700
<https://www.resinarchitecture.com/>



SD8 - EXTERIOR VIEW

3/25/2022

LOWER VALLEY REGIONAL HUMAN SERVICES FACILITY - 21032
NEW PHASED DEVELOPMENT

Information shown on this drawing sheet is PRELIMINARY & NOT FOR CONSTRUCTION



RESIN
ARCHITECTURE

305 1st STREET,
IDAHO FALLS, ID 83401
PH: 208.757.5700
<https://www.resinarchitecture.com/>

THESE PLANS, DRAWINGS, AND DESIGNS ARE THE EXCLUSIVE PROPERTY OF RESIN ARCHITECTURE, LLC AND SHALL NOT BE REPRODUCED IN ANY FORM WITHOUT WRITTEN CONSENT. ALL RIGHTS RESERVED © 2022 RESIN ARCHITECTURE, LLC.



SD9 - EXTERIOR VIEW

3/25/2022

LOWER VALLEY REGIONAL HUMAN SERVICES FACILITY - 21032
NEW PHASED DEVELOPMENT

Information shown on this drawing sheet is PRELIMINARY & NOT FOR CONSTRUCTION



RESIN
ARCHITECTURE

305 1st STREET,
IDAHO FALLS, ID 83401
PH: 208.757.5700
<https://www.resinarchitecture.com/>

THESE PLANS, DRAWINGS, AND DESIGNS ARE THE EXCLUSIVE PROPERTY OF RESIN ARCHITECTURE, LLC AND SHALL NOT BE REPRODUCED IN ANY FORM WITHOUT WRITTEN CONSENT. ALL RIGHTS RESERVED © 2022 RESIN ARCHITECTURE, LLC.



SD10 - EXTERIOR VIEW

3/25/2022

LOWER VALLEY REGIONAL HUMAN SERVICES FACILITY - 21032
NEW PHASED DEVELOPMENT

Information shown on this drawing sheet is PRELIMINARY & NOT FOR CONSTRUCTION



RESIN
ARCHITECTURE

305 1st STREET,
IDAHO FALLS, ID 83401
PH: 208.757.5700
<https://www.resinarchitecture.com/>

THESE PLANS, DRAWINGS, AND DESIGNS ARE THE EXCLUSIVE PROPERTY OF RESIN ARCHITECTURE, LLC AND SHALL NOT BE REPRODUCED IN ANY FORM WITHOUT WRITTEN CONSENT. ALL RIGHTS RESERVED © 2022 RESIN ARCHITECTURE, LLC.